Guide to Contract Reference Selections

**1.00 Final
March 2019**

Gas Supply Hub



Important Notice

PURPOSE

This Guide to Contract Reference Selections (Guide), prepared by the Australian Energy Market Operator (AEMO), provides guidance for Contract Reference Selections under the National National Gas Rules (NGR) (Rules).

NO RELIANCE OR WARRANTY

This document does not constitute legal or business advice, and should not be relied on as a substitute for obtaining detailed advice about the National Gas or Electricity Law, the Rules or any other applicable laws, procedures or policies. While AEMO has made every effort to ensure the quality of the information in this Guide, neither AEMO, nor any of its employees, agents and consultants make any representation or warranty as to the accuracy, reliability, completeness, currency or suitability for particular purposes of that information.

LIMITATION OF LIABILITY

To the maximum extent permitted by law, AEMO and its advisers, consultants and other contributors to this Guide (or their respective associated companies, businesses, partners, directors, officers or employees) are not liable (whether by reason of negligence or otherwise) for any errors, omissions, defects or misrepresentations in this document, or for any loss or damage suffered by persons who use or rely on the information in it.

TRADEMARK NOTICES

Microsoft is a trademark of Microsoft Corporation in the United States and/or other countries.
Oracle and Java are registered trademarks of Sun Microsystems, Inc. in the U.S. and other countries.

DISTRIBUTION

Available to the public.

DOCUMENT IDENTIFICATION

Business custodian: Manager, Market Design
IT custodian: Manager - NEM Dispatch and Forecasting Systems
Prepared by: Technology, Technical Writers

VERSION HISTORY

Version 1.00. Initial creation.
Last update: Monday, 4 March 2019 3:37 PM

DOCUMENTS MADE OBSOLETE

The release of this document changes any previous versions of Guide to Contract Reference Selections.

Contents

Chapter 1 Introduction	1
Purpose	1
Audience	1
What's in this guide	1
How to use this guide	2
Chapter 2 About Contract Reference Selections	3
What Contract Reference Selections is for	3
Who can use Contract Reference Selections	3
How to use Contract Reference Selections	4
Process	5
User rights access	5
System requirements	6
Environment access	7
Supported web browsers	7
Chapter 3 Access Contract Reference Selections	8
Chapter 4 Create New Contract Reference Selections	10
Use same for either net buy or sell	11
Use different for net buy and net sell	13
Adding or removing multiple steps	14
Chapter 5 View or Edit Contract Reference Selections	16
View list of Contract Reference Selections	16
View or Edit Contract Reference Selections	18
Chapter 6 Delete Contract Reference Selections	19
Needing Help	20
AEMO's Support Hub	20
Feedback	21
References	22
AEMO's website	22
Glossary	23
Index	26

Chapter 1 Introduction

Purpose	1
Audience	1
What's in this guide	1
How to use this guide	2

Purpose

This guide explains how to set up Contract References in the GSH Capacity Trading Platform.

Audience

The primary audience for this guide is registered *GSH Trading Participants* who are trading capacity and using the GSH Contract Reference Selections web application.

A secondary audience is Participant Administrators providing access for their company's Participant Users to access the GSH Contract Reference Selections web application.

What's in this guide

Chapter 2 About Contract Reference Selections on page 3 provides an overview of Contract Reference Selections, who can use it, system requirements, and user rights access.

Chapter 3 Access Contract Reference Selections on page 8 explains how to access Contract Reference Selections.

Chapter 4 Create New Contract Reference Selections on page 10 explains how to create new Contract Reference Selections.

Chapter 5 View or Edit Contract Reference Selections on page 16 explains how to view or edit Contract Reference Selections that you already have set up.

[Chapter 6 Delete Contract Reference Selections on page 19](#) explains how to delete Contract Reference Selections.

[Needing Help on page 20](#) provides a list of related resources, information about contacting AEMO's Support Hub, and how to provide feedback.

[References on page 22](#) is a list of the references mentioned throughout this guide.

[Glossary on page 23](#) contains an explanation of the capitalised terms and abbreviations used throughout this guide.

How to use this guide

- This document is written in plain language for easy reading.
- Where there is a discrepancy between the Rules, and information or a term in this document, the Rules take precedence.
- Where there is a discrepancy between the **Capacity Transfer and Auction Procedures**, the procedures take precedence.
- **Text in this format** indicates a hyperlink to related information.
- **Text in this format** indicates there is a resource on AEMO's website. For details, see [References on page 22](#).
- Glossary terms are capitalised and have the meanings listed against them.
- *Italicised terms* are defined in the National Gas Rules (NGR). Any rules terms not in this format still have the same meaning.
- Actions to complete in the web portal interface are **bold and dark grey**.

Chapter 2 About Contract Reference Selections

This chapter provides an overview of the Contract Reference Selections, who can use it, system requirements, and user rights access.

What Contract Reference Selections is for	3
Who can use Contract Reference Selections	3
How to use Contract Reference Selections	4
Process	5
User rights access	5
System requirements	6
Environment access	7
Supported web browsers	7

What Contract Reference Selections is for

Trading Participants use the Contract Reference Selections web application to set preferences as part of the GSH Gas Supply Hub.

Setting up Contract Reference Selections is a prerequisite to submitting trades on the Gas Supply Hub.

Who can use Contract Reference Selections

Registered *Trading Participants* and AEMO have access to the information in the system in accordance with the National Gas Rules (NGR).

How to use Contract Reference Selections

Contract Reference Selections is a web application in the EMMS Markets Portal. You can find it under the **Delivery Netting Preferences** menu.



Prerequisites

Gas Supply Hub

Before registered *Trading Participants* can set their Contract Reference Selections, *Facility Operators* supply AEMO a list of valid Service Provider References for their facilities.

For a list of all valid Service Provider References, see the **Contract Details** report in the **Guide to Capacity Trading and Day Ahead Auction Reports**.

Contract Reference Selections

Setting Contract Reference Selections is a prerequisite to submitting trades on the Gas Supply Hub because each submitted trade uses the preferences you set as part of the trade submission.

Process

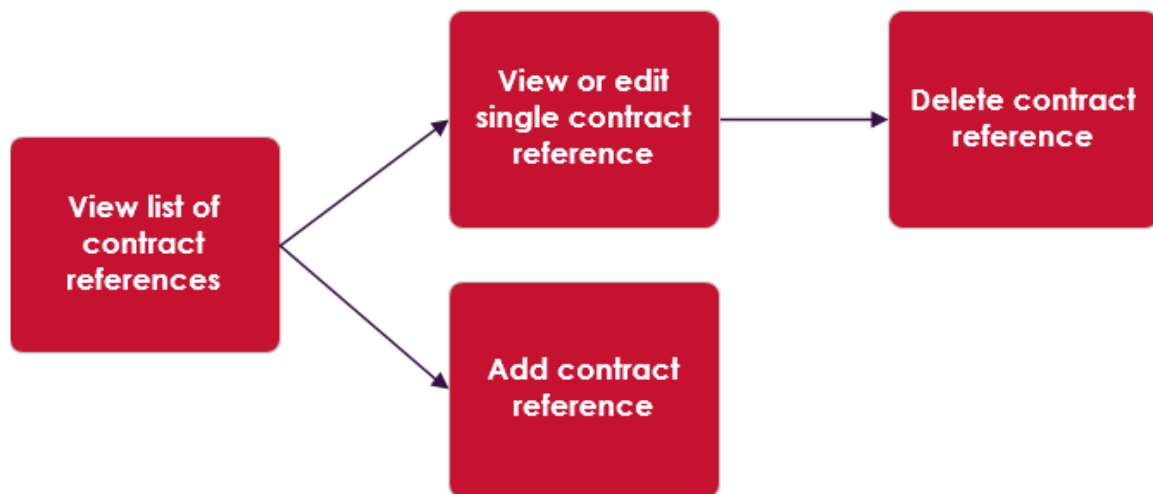

User rights access

To access Contract Reference Selections, Participant Users must have the appropriate user rights access. The access right determines the functionalities and transactions you can use to access the web portal, batch interfaces, FTP, and API services.

Your company's Participant Administrator (PA) provides access to Contract Reference Selections for Participant Users in the **MSATS>Administration>Maintain Entities** menu, using the following entity:

- GSH - Contract References

If you don't know who your company's PA is, contact AEMO's Support Hub.

Setting a participant

Where a Participant User has user rights assigned by more than one Participant ID, they select the Participant ID they want to represent using the **Set Participant** option, without having to log out, change IDs and log in again. For help using Set Participant, see **Setting a participant** in the Markets Portal Help.

For more details about participant administration and user rights access, see **Guide to User Rights Management**.

The participant you are acting for displays in the web portal interface. For permission to see other participant IDs using Set Participant, see your company's PA.

When you are using the Set Participant function, you can only log into the Markets Portal once on the same computer.

System requirements

You access the Contract Reference Selections web application using a web browser. You require:

- The website address where the application is located on AEMO's network:
 - Pre-production: <https://portal.preprod.nemnet.net.au>
 - Production: <https://portal.prod.nemnet.net.au>
 - Markets Portal help: <https://portal.preprod.nemnet.net.au/help>
- Either the current or previous versions of Microsoft Internet Explorer or Google Chrome.
- Access to MarketNet. If your company is a registered participant, you probably already have access because it is set up during the registration process. For more details, see **Guide to Information Systems**.
- A monitor capable of 1024 x 768 screen resolution.

A user ID and password provided by your company's participant administrator (PA) who controls access to AEMO's web portals. For more details see **Guide to User Rights Management**.

PAs are set up during the registration process, if you don't know who your company's PA is, contact AEMO's Support Hub [AEMO.Support Hub email].

For the best experience, AEMO recommends using the current or previous version of Google Chrome.

Contract Reference Selections runs on both Windows and Unix-like operating systems.

Environment access

The Markets Portal gives you a clear indication of the environment you are working in by providing a different background colour for the menu:

- The pre-production environment has a green menu background
- The production environment has a blue menu background.

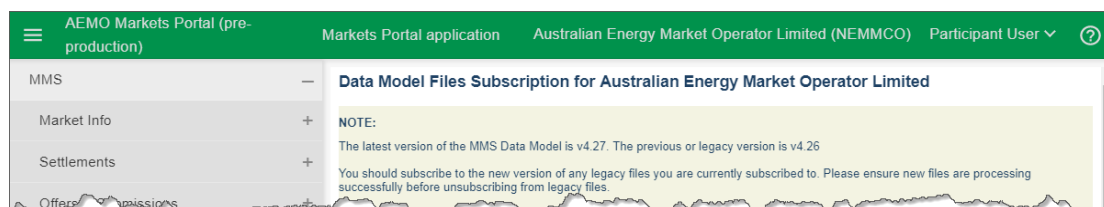

Supported web browsers

Contract Reference Selections runs on both Windows and Unix-like operating systems. To access the Markets Portal, AEMO recommends the following web browsers:

Browser	Platform	Current	More information
Microsoft Internet Explorer	Windows	IE11	https://www.whatismybrowser.com/guides/the-latest-version/internet-explorer
Microsoft Edge (Microsoft recommended)	Windows 10	Edge	https://www.microsoft.com/en-au/windows/microsoft-edge
Google Chrome	All platforms	71 (Nov 2018)	https://www.whatismybrowser.com/guides/the-latest-version/chrome

Chapter 3 Access Contract Reference Selections

This chapter explains how to access Contract Reference Selections.

1. Using your web browser, access the Web Portal, either:
 - Pre-production: <https://portal.preprod.marketnet.net.au>
 - Production: <https://portal.prod.marketnet.net.au>

The Web Portal gives you a clear indication of the environment you are working in by providing a different border colour around the home page. The production environment has a grey border and the pre-production environment has a green border.

2. Sign in using the user ID and password provided by your company's PA.
3. Under Gas Supply Hub, select **Delivery Netting Preferences**, and then **View Contract References**.
4. The current Contract Reference Selections list displays. For help with the fields, see [View or Edit Contract Reference Selections on page 16](#).

If you have not created any Contract Reference Selections, your list is empty.

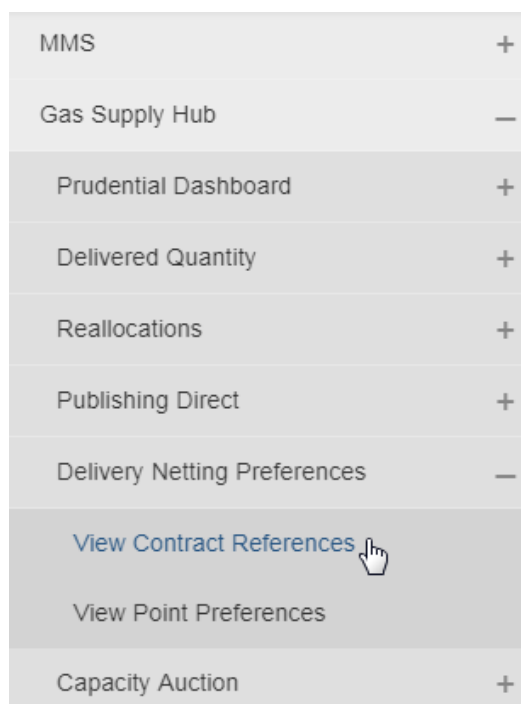

MMS	+
Gas Supply Hub	-
Prudential Dashboard	+
Delivered Quantity	+
Reallocations	+
Publishing Direct	+
Delivery Netting Preferences	-
View Contract References	
View Point Preferences	
Capacity Auction	+

Figure 1 Current Contract References list

Contract References

Participant:

From Date:

To Date:

Current References

Product	Start Date	End Date	
GAS-EPG-LON-DZS	19/11/2018	20/11/2018	View/Edit
GAS-EPG-LON-DZS	21/11/2018	10/11/2019	View/Edit
GAS-EPG-LON-DZS	11/11/2019	19/11/2019	View/Edit
GAS-RBP-DAR-WAL	19/11/2018	28/11/2018	View/Edit

[New](#)

Chapter 4 Create New Contract Reference Selections

This chapter explains how to create new Contract Reference Selections.

Use same for either net buy or sell	11
Use different for net buy and net sell	13
Adding or removing multiple steps	14

To create a new Contract Reference:

1. Access Contract Reference Selections, for help, see [Access Contract Reference Selections on page 8](#).
2. Click New. For help with items 1 to 4, see [Access Contract Reference Selections on page 8](#).

Contract References 1

Participant:
Energy Retail Ltd

From Date: 15/11/2018 To Date: 15/11/2019

Current References

Product	Start Date	End Date	Action
---------	------------	----------	--------

Now 2

3. Select the **Product** you want to set a contract reference for.
4. Select the **Start** and **End Dates**. If no Contract Reference Selections exist for the selected Product for the specified date range, a message alerts you and you cannot continue.

Contract References

Participant:

Product:

Start Date:

End Date:

 Use same for either net buy or sell

 Use different for net buy and net sell

5. Select one of these options and follow the instructions:

- Use same for either net buy or sell below** is the default selection. Select this option so the same Contract Reference Selections are used for both buy and sell.
- Use different for net buy and net sell on page 13** select this option to set up Contract Reference Selections for either buy, or sell, or both.

Use same for either net buy or sell

Selecting this option means:

If the *Trading Participants'* net position in that product at the time of netting is a buy position, the contract selected for **buy** is applied.

For help, see [Figure 2](#).

6. Click **Use same for either net buy or sell**.
7. Under **Both References**, for each Contract Reference Selections step:
 - a. Select the **Service Reference**. This is the reference number for the service with the *facility operator*.
If there are several **Service References** you can use multiple steps. For help, see [Adding or removing multiple steps on page 14](#).
If the selected **Product** spans multiple facilities you must select at least one for each facility.
For a list of all valid Service Provider References, see the **Contract Details** report in the [Guide to Capacity Trading and Day Ahead Auction Reports](#).
 - b. Select the **STTM CRN**. Only required for **integrated STTM products**. If there are entries in the list you must select one.
 - c. Select the **DWGM Reference**. Only required if a participant is trading capacity for use at a DWGM accredited point. If there are entries in the list you must select one.
 - d. Except for the last step, enter the **Volume** in Gigajoules (GJ). The volume must be in the range of 500 to 1000000.
 - e. If required, add more steps and follow steps a to d. For help, see [Adding or removing multiple steps on page 14](#).
7. Click **Submit**.
Alternatively:
 - a. To make your entries again, click **Reset Interface**.
 - b. To exit the new submission, click **Cancel**.
8. A confirmation report called **Contract References** is available in **GSH Publishing Direct** or over **Data Interchange**. For help see [Guide to GSH Publishing Direct](#) and [Guide to Data Interchange](#).

Contract Reference Selections can have several steps if there are different STTM CRN and DWGM References for the contract. For help see [Adding or removing multiple steps on page 14](#).

Figure 2 Use same for either net buy or sell

6 Use same for either net buy or sell Use different for net buy and net sell

Both References 7

	Service Reference	STTM CRN	DWGM Reference	Volume
1	SATHEESTHTEST1-Forward Haul - NSW1	Not Required	A-30000001PC	50000
2				

8

Use different for net buy and net sell

For help, see [Figure 3](#)

6. Click **Use different for net buy and net sell**.
7. Under **Buy References** and **Sell References**, for each step, enter the **Service Reference**, **STTM CRN**, **DWGM Reference**, **Volume** as in [Use same for either net buy or sell on page 11](#).
For help with steps, see [Adding or removing multiple steps on the next page](#).
8. Click **Submit**.
Alternatively:
 - a. To make your entries again, click **Reset Interface**.
 - b. To exit the new submission, click **Cancel**.
9. A confirmation report called **Contract References** is available in **GSH Publishing Direct** or over **Data Interchange**. For help see [Guide to GSH Publishing Direct](#) and [Guide to Data Interchange](#).

Figure 3 Use different for net buy and net sell

Use same for either net buy or **6** Use different for net buy and net sell

7 Buy References Sell References

	Service Reference	STTM CRN	DWGM Reference	Volume		Service Reference	STTM CRN	DWGM Reference	Volume
1	SATHEESTHTEST6-Compressor	Not Required	Not Required	50000	1	SATHEESTHTEST6-Compressor	Not Required	Not Required	20000

8 Submit Reset Interface Cancel

Adding or removing multiple steps

The reason for multiple steps is to have different volumes in different contracts, for example:

If you enter a volume of 1,000 GJ in the first row and nothing in the second row, the first 1,000 GJ is used for the first contract reference and the second row uses the balance.

To add a step:

- Right click the table and select **Insert row above or below** (as appropriate). For help, see [Figure 4](#)

To remove a step:

- Right click the row and select **Remove row**.

Figure 4 Insert or remove row

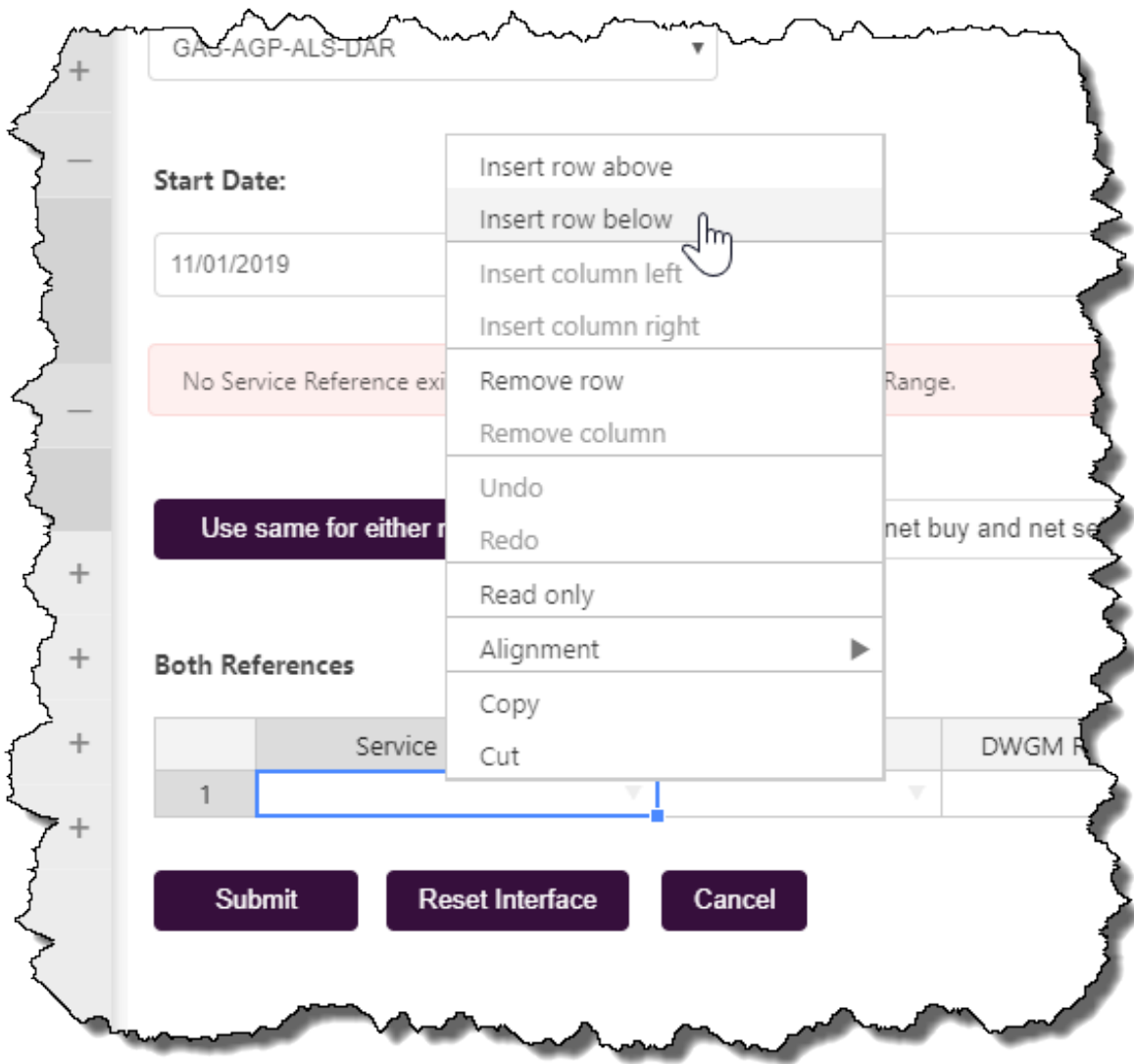

Chapter 5 View or Edit Contract Reference Selections

This chapter explains how to view or edit Contract Reference Selections you have already set up.

View list of Contract Reference Selections	16
View or Edit Contract Reference Selections	18

View list of Contract Reference Selections

To view the list of required Contract Reference Selections:

1. Access Contract Reference Selections, for help, see [Access Contract Reference Selections on page 8](#).
2. In the Contract Reference Selections interface, select the **From Date**. It is any time from the implementation of the netting process (1 March 2019 in production) to the current date.

2. Select the **To Date**. It is also any time from the implementation of the netting process production) to the current date. It cannot be less than the **From Date**.
3. After you select the **To Date**, the list changes to display the Contract Reference Selections for the specified date range.

To view or edit Contract Reference Selections, see [View or Edit Contract Reference Selections on the next page](#).

Contract References

Participant:
Origin Energy Retail Ltd

From Date: 16/11/2018 **To Date:** 16/11/2018

November 2018

Sun	Mon	Tue	Wed	Thu	Fri	Sat
28	29	30	31	1	2	3
4	5	6	7	8	9	10
11	12	13	14	15	16	17

Contract References

Participant:

Energy Retail Ltd 1

From Date:

14/11/2018 2

To Date:

14/11/2019 3

Current References

Product 4	Start Date 5	End Date 6	Action 7
GAS-EPG-LON-DZS	14/11/2018	10/11/2019	View/Edit
GAS-EPG-LON-DZS	11/11/2019	14/11/2019	View/Edit
GAS-WCFA	14/11/2018	08/11/2019	View/Edit
GAS-WCFA	09/11/2019	10/11/2019	View/Edit

New 8

Explanation

1. Displays the **Participant ID** belonging to the current Contract Reference Selections.
2. The **From Date** is the current date minus one day.

3. The default **To Date** is the current date, plus one year, minus one day.
4. The **Product** column displays the effective Contract Reference Selections for the **From and To Dates**.
5. The **Start Date** of the Contract Reference Selections.
6. The **End Date** of the Contract Reference Selections.
7. Click **View/Edit** to see the Contract Reference details or to edit the Contract Reference. For help, see **Figure 1**.
8. Select **New** to add new Contract Reference Selections, see **Create New Contract Reference Selections on page 10**.

View or Edit Contract Reference Selections

1. Follow the steps for **View list of Contract Reference Selections on page 16**
2. Find the Contract Reference you want to view or edit and in the **Action** column, click **View/Edit**.
3. Follow the steps for **Create New Contract Reference Selections on page 10**.

Chapter 6 Delete Contract Reference Selections

This chapter explains how to delete Contract Reference Selections.

To delete Contract Reference Selections you need to override an existing contract:

1. **Create a new contract** for the **exact same** date range as the one you want to delete.
2. Your original contract is overridden and replaced with this new contract.

Needing Help

AEMO's Support Hub	20
Feedback	21

AEMO's Support Hub

IT assistance is requested through one of the following methods:

- Phone: 1300 AEMO 00 (1300 236 600)

For non-urgent issues, normal coverage is 8:00 AM to 6:00 PM on weekdays, Australian Eastern Standard Time (AEST).

- The **Contact Us** form on AEMO's website.

AEMO recommends participants call AEMO's Support Hub for all urgent issues, whether or not you have logged a call using the contact us form.

Information to provide

Please provide the following information when requesting assistance from AEMO:

- Your name
- Organisation name
- Participant ID
- System or application name
- Environment: production or pre-production
- Problem description
- Screenshots

For AEMO software-related issues please also provide:

- Version of software
- Properties or log files
- PDR Monitor support dump and Data Interchange (DI) instance name (if DI problem)

Feedback

Your feedback is important and helps us improve our services and products. To suggest improvements, please contact AEMO's Support Hub.

References

AEMO's website

Capacity Transfer and Auction Procedures, made under section 91BRP of the National Gas Law (NGL) for the regulation of the capacity auction and transaction support arrangements.

Guide to Capacity Trading and Day Ahead Auction Reports, provides details about the capacity transfer and day-ahead auction market CSV reports.

Guide to Data Interchange assists participants to understand AEMO's Data Interchange software components. It describes how to set up a standard Data Interchange environment to replicate data between AEMO's energy market systems and participants' local DBMS conforming to the MMS Data Model.

Guide to GSH Publishing Direct, explains how to use the Publishing Direct web application in AEMO's Markets Portal.

Markets Portal Help, online searchable help for the Markets Portal web applications. Only available over a **MarketNet** connection:
<https://portal.preprod.nemnet.net.au/help>.

For a list of all valid Service Provider References, see the **Contract Details report in the Guide to Capacity Trading and Day Ahead Auction Reports**.

Glossary

AEMC

Australian Energy Market Commission

AEMO

Australian Energy Market Operator

AER

The Australian Energy Regulator, established by section 44AE of the Trade Practices Act 1974.

AEST

Australian Eastern Standard Time

API

Application Programming Interface; a set of clearly defined methods of communication between various software components.

Capacity Product

Capacity on pipeline or compressor infrastructure.

Contract Preferences

The preferences of a Shipper for contracts or agreements they want to trade against.

Contract Reference

A reference number to a contract or agreement held by the Shipper and the Facility Operator to trade capacity on a facility. This is a collective term that includes the Service Provider Reference,

DWGM Reference, and STTM Customer Registration Number.

Contract Reference Selection

The Contract References selected by the participant for netting.

CRN

Customer Registration Number

CSV

Comma-separated values; a file format for exchanging data.

CTP

Capacity Trading Platform

DWGM

Declared Wholesale Gas Market

DWGM Reference

AEMO's reference number to the agreement between a Shipper and Facility Operator for Capacity Trading on the DWGM.

EMMS

Wholesale Electricity Market Management System; software, hardware, network and related processes to implement the energy market.

FO

Facility operator

FTP

File transfer protocol; a standard network protocol used for the transfer of computer files between a client and server on a computer network.

GJ

Gigajoule

GSH

Gas Supply Hub

MarketNet

AEMO's private network available to participants having a participant ID

Markets Portal

Web portal for access to AEMO's wholesale web-based applications.

MSATS

Retail Market Settlement and Transfer Solution

MSATS Web Portal

MSATS web-based interactive interface

MW

Megawatt

NEM

National Electricity Market

PA

Participant Administrator who manages participant company's user access and security. The initial PA is set up by the AEMO system administrator as part of the registration process.

Participant File Server

Each Participant ID has secure read-write access to their own set of folders, plus read-only access to folders accessible by all participants (public data). The private folders are for secure transfer of data between the Participant ID systems and AEMO (such as, bidding and settlement invoices).

Participant ID

Registered participant identifier

Participant user ID

The user ID you used to login to the system.

Participant Users

Set up by the company's Participant Administrator.

Pre-production

AEMO's test system available to participants

Production

AEMO's live system

Service Provider Reference

The Facility Operator's reference number for the agreement between themselves and Shippers for Capacity Trading.

STTM

Short-Term Trading Market

URM

User Rights Management; see the Guide to URM on AEMO's website

ZIP

The file compression format used for exchanging data with AEMO.

Index

A

About 3
add a step 14
Adding new steps 14

B

Buy References 13

D

delete 19
DWGM Reference 12

E

Environment access 7

F

Feedback 21

G

Glossary 23

I

Insert row above 14

M

Markets Portal Help 22

P

Prerequisites 4
Process 5

R

remove a step 14
Remove row 14

S

Sell References 13
Setting a participant 5
STTM CRN 12
Supported web browsers 7

U

Use different for net buy and net sell 13
Use same for either net buy or sell 11
User rights access 5

V

Volume 12

W

Web portal requirements 6